

ES25

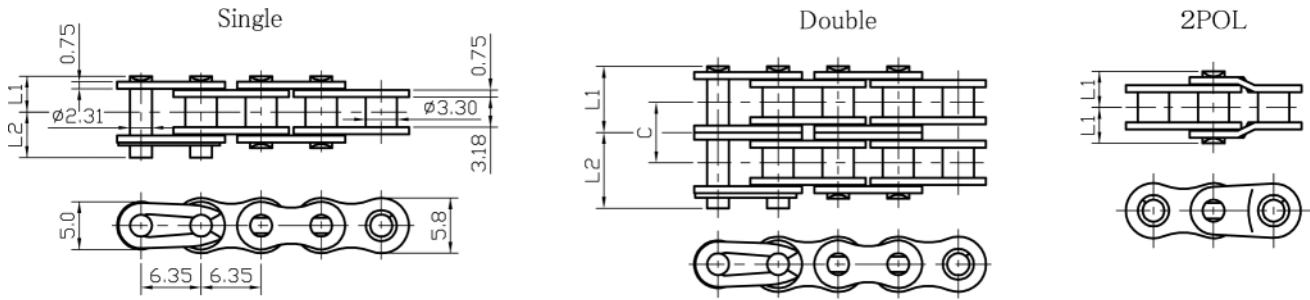

IZUMI	Pitch	Pin Length L1 + L2	Dimension L1	Dimension L2	Transverse Pitch C	Average Tensile Strength (kN)	Maximum Allowable Load (kN)	Weight (kg/m)
Chain No.								
ES25	6.35	8.4	3.8	4.6	6.4	4.50	0.64	0.14
ES25-2		7.0	7.8	14.8		9.10	1.08	0.27

Note : Only two-pitch offset links are available for ES25 and ES25-2.

ES410

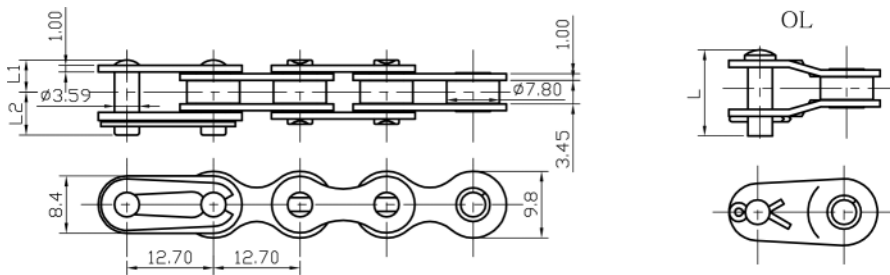

IZUMI	Pitch	Pin Length L1 + L2	Dimension L1	Dimension L2	Offset Pin Length L	Minimum Tensile Strength (kN)	Weight (kg/m)
Chain No.							
ES410	12.70	11.0	4.7	6.3	12.45	8.14	0.27
ES410SS		10.9	4.9	6.0	12.4	5.88	0.27

ES35

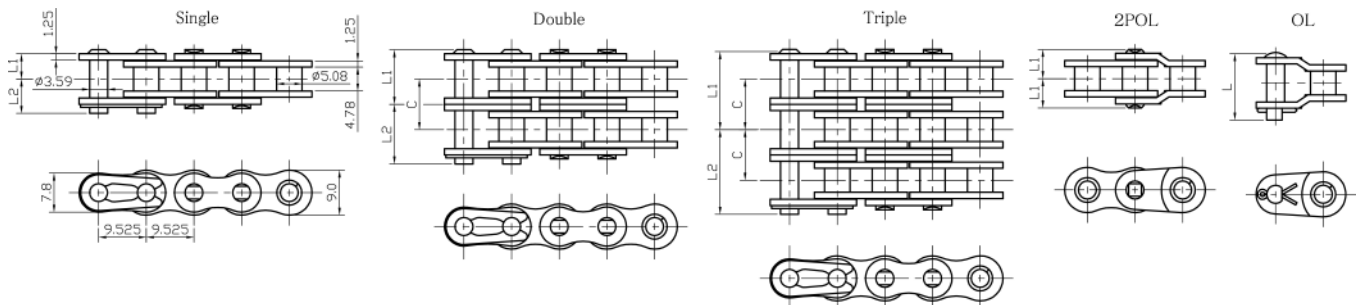

IZUMI	Pitch	Pin Length L1 + L2	Dimension L1	Dimension L2	Offset Pin Length L	Transverse Pitch C	Average Tensile Strength (kN)	Maximum Allowable Load (kN)	Weight (kg/m)
Chain No.									
ES35	9.525	12.7	5.85	6.85	13.5	10.1	11.30	2.16	0.33
ES35-2		22.8	10.9	11.9	24.5		22.60	3.63	0.69
ES35-3		32.9	16.0	16.9	34.6		33.80	5.39	1.05

Specifications are subject to change without notice.

ES40

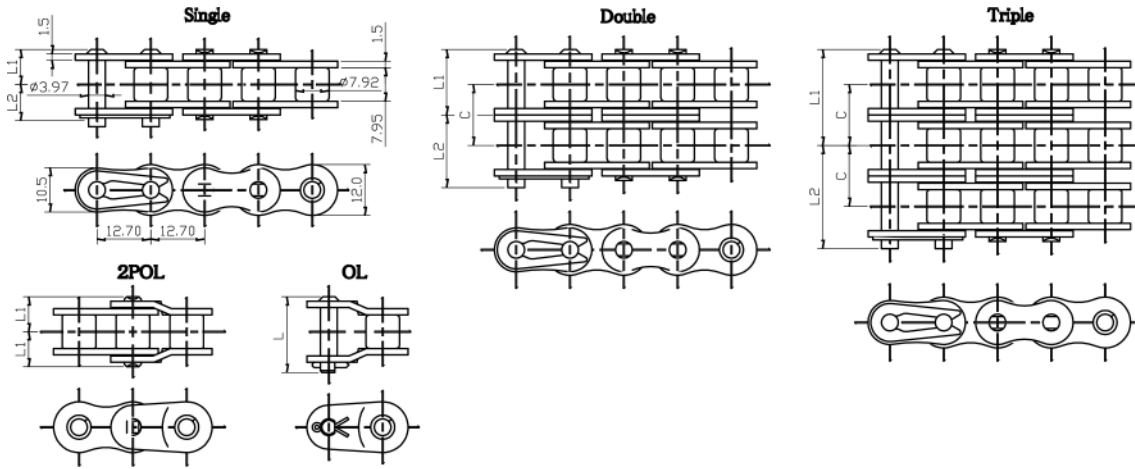

IZUMI Chain No.	Pitch	Pin Length L1 + L2	Dimension L1	Dimension L2	Offset Pin Length L	Transverse Pitch C	Average Tensile Strength (kN)	Maxmum Allowable Load (kN)	Weight (kg/m)
ES40	12.70	18.2	8.25	9.95	18.0	14.4	19.1	3.63	0.64
ES40-2		32.6	15.45	17.15	33.5		38.2	6.18	1.27
ES40-3		46.8	22.65	24.15	47.9		57.4	9.12	1.9
ES40-4		61.2	29.9	31.3	62.3		76.5	12.0	2.5
ES40-5		75.7	37.1	38.6	76.8		95.6	14.1	3.16
ES40-6		90.1	44.3	45.8	91.2		115	16.7	3.79

ES50

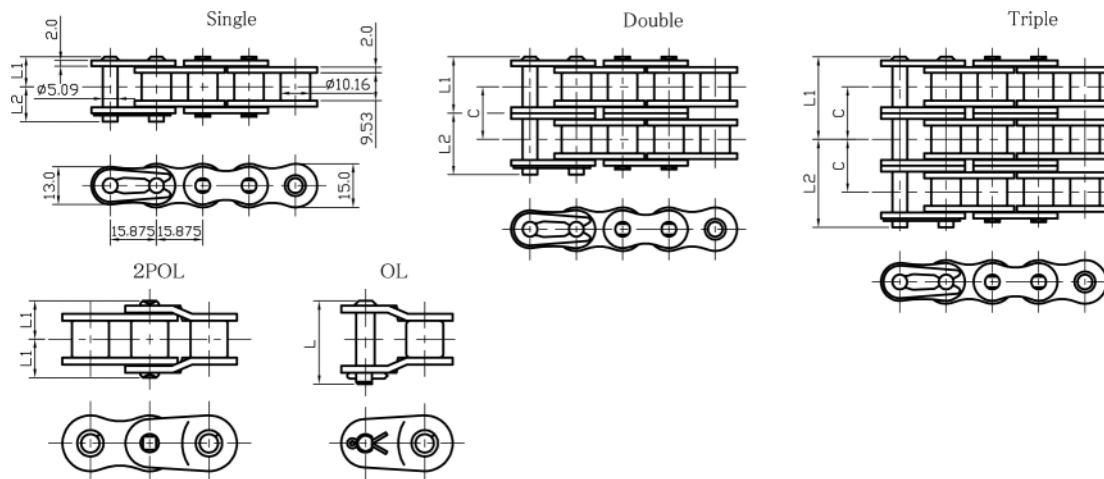

IZUMI Chain No.	Pitch	Pin Length L1 + L2	Dimension L1	Dimension L2	Offset Pin Length L	Transverse Pitch C	Average Tensile Strength (kN)	Maxmum Allowable Load (kN)	Weight (kg/m)
ES50	15.875	22.3	10.3	11.9	22.5	18.1	31.4	6.37	1.04
ES50-2		40.5	19.35	21.15	41.8		62.8	10.7	2.07
ES50-3		58.6	28.4	30.2	59.9		94.1	16	3.09
ES50-4		76.7	37.45	39.25	48.1		126	21.1	4.1
ES50-5		94.8	46.5	48.3	96.2		157	24.9	5.14
ES50-6		113.0	55.6	57.4	114.4		188	29.3	6.16

Specifications are subject to change without notice.

ES60

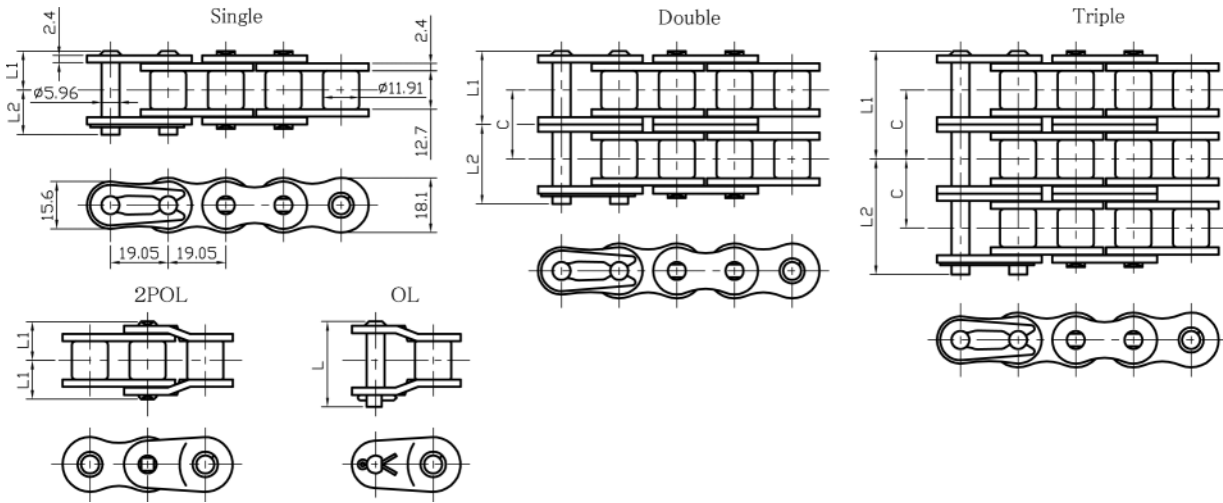

IZUMI Chain No.	Pitch	Pin Length L1 + L2	Dimension L1	Dimension L2	Offset Pin Length L	Transverse Pitch C	Average Tensile Strength (kN)	Maxmum Allowable Load (kN)	Weight (kg/m)
ES60	19.05	27.6	12.85	14.75	28.2	22.8	44.1	8.8	1.53
ES60-2		50.5	24.25	26.25	52.6		88.3	15.0	3.04
ES60-3		73.8	35.65	38.15	75.5		132.0	22.1	4.54
ES60-4		96.6	47.05	49.55	98.3		177.0	29.1	6.0
ES60-5		119.5	58.5	61.0	121.2		221.0	34.4	7.54
ES60-6		142.4	69.9	72.5	144.0		265	40.6	9.05

SS Series

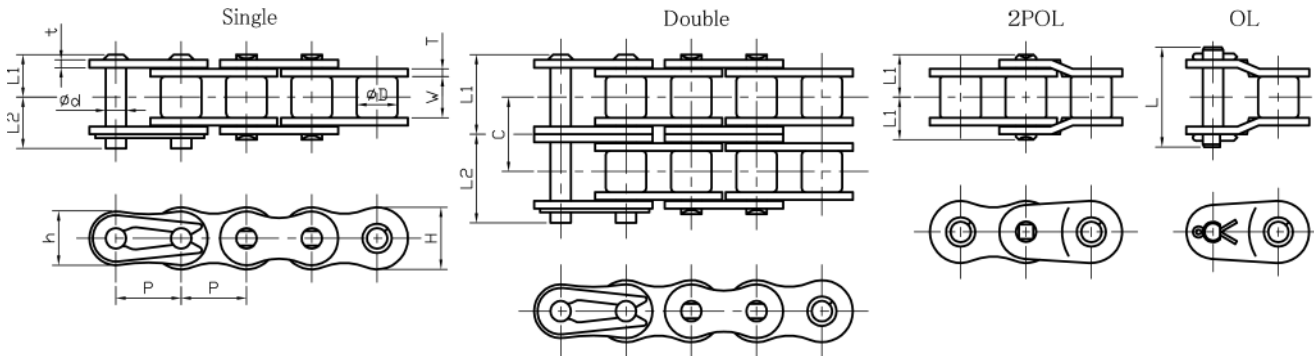

IZUMI Chain No.	Pitch	Pin			Transverse Pitch C	Roller		Plate				Maxmum Allowable Load (kN)	Weight (kg/m)
		Diamater d	Length L1	Length L2		Diamater D	Width W	thickness t	thickness T	Height h	Height H		
ES25SS	6.35	2.31	3.8	4.4	-	3.3	3.18	0.75	0.75	5.0	5.8	0.12	0.14
ES35SS	9.525	3.59	5.85	6.85	-	5.08	4.78	1.25	1.25	7.8	9.0	0.26	0.33
ES35SS-2			11.05	11.95	10.1							0.51	0.69
ES40SS	12.70	3.87	8.25	9.65	-	3.97	7.95	1.5	1.5	10.4	12.0	0.44	0.64
ES40SS-2			15.45	17.15	14.4							0.88	1.27
ES50SS	15.875	5.09	10.3	12.0	-	10.16	9.53	2.0	2.0	13.0	15.0	0.69	1.04
ES50SS-2			19.35	21.05	18.1							1.37	2.07
ES60SS	19.05	5.96	12.85	15.25	-	11.91	12.7	2.4	2.4	15.6	18.1	1.03	1.53
ES60SS-2			24.25	26.15	22.8							2.06	3.04

Specifications are subject to change without notice.

EF Series

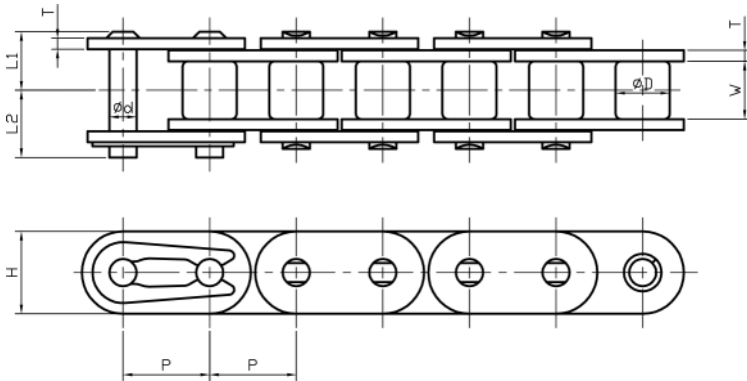

IZUMI Chain No.	Pitch	Pin			Roller		Plate		Maximum Allowable Load (kN)	Weight (kg/m)
		Diameter d	Length L1	Length L2	Diameter D	Width W	thickness T	Height H		
EF40	12.70	3.97	8.25	9.95	7.92	7.95	1.5	12.3	2.65	0.74
EF50	15.875	5.09	10.3	11.9	10.16	9.53	2.0	15.0	4.31	4.31
EF60	19.05	5.96	12.85	14.75	11.91	12.7	2.4	18.1	6.28	1.78
EF40SS	12.70	3.97	8.25	9.65	7.92	7.95	1.5	12.3	0.44	0.74
EF50SS	15.875	5.09	10.3	12.0	10.16	9.53	2.0	15.0	0.69	4.31
EF60SS	19.05	5.96	12.85	14.75	11.91	12.7	2.4	18.1	1.03	1.78

Specifications are subject to change without notice.

EF06B

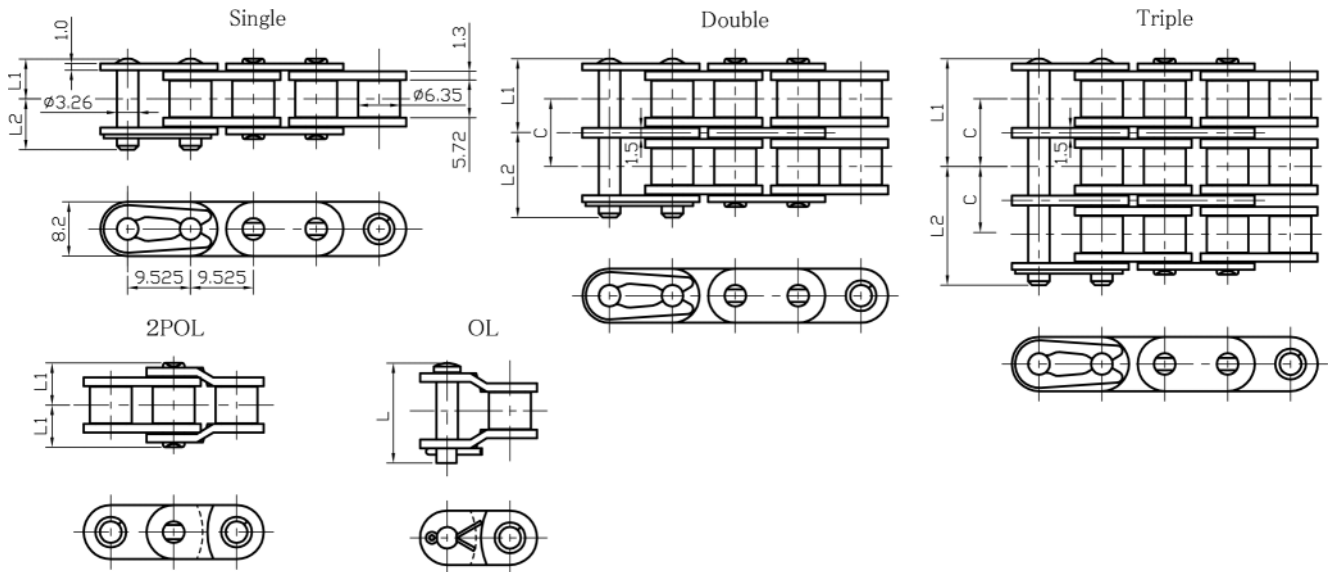

IZUMI	Pitch	Pin Length L1 + L2	Dimension L1	Dimension L2	Offset Pin Length L	Transverse Pitch C	Minimum Tensile Strength (kN)	Weight (kg/m)
Chain No.								
EF06B	9.525	13.8	6.1	7.7	15.1	10.24	9.0	0.39
EF06B-2		24.0	11.2	12.8	25.9		17.0	0.75
EF06B-3		34.3	16.4	17.9	36.1		24.9	1.11

ES08B

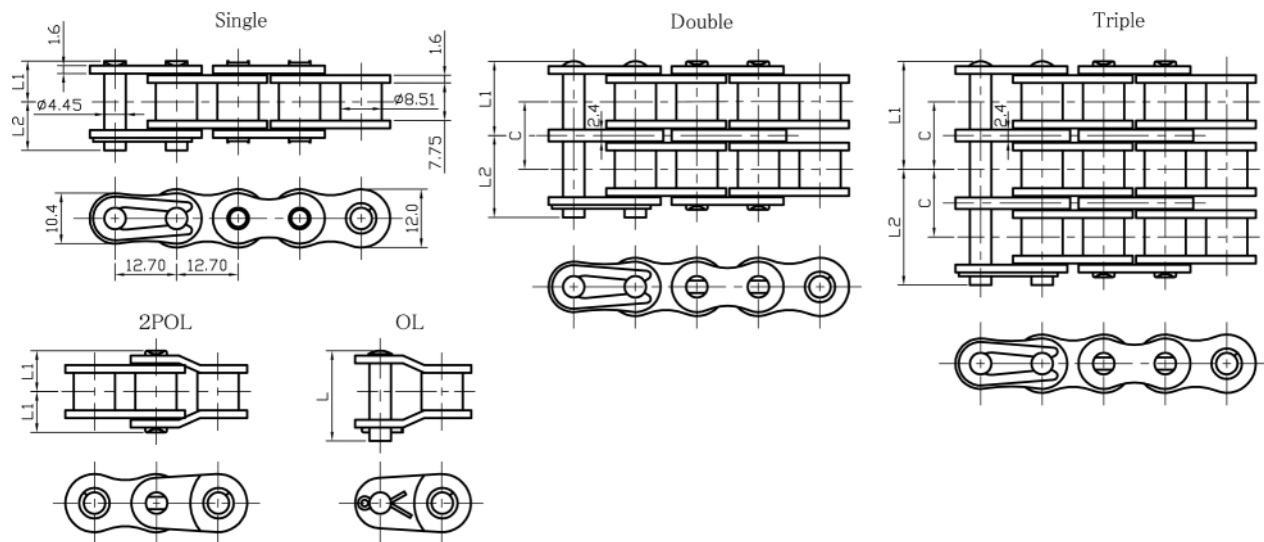

IZUMI	Pitch	Pin Length L1 + L2	Dimension L1	Dimension L2	Offset Pin Length L	Transverse Pitch C	Minimum Tensile Strength (kN)	Weight (kg/m)
Chain No.								
ES08B	12.70	18.4	8.4	10.0	18.4	13.92	19.0	0.7
ES08B-2		32.2	15.3	16.9	33.6		32.0	1.35
ES08B-3		46.1	22.25	23.85	47.6		47.5	2.00

Specifications are subject to change without notice.

ES10B & ES12B

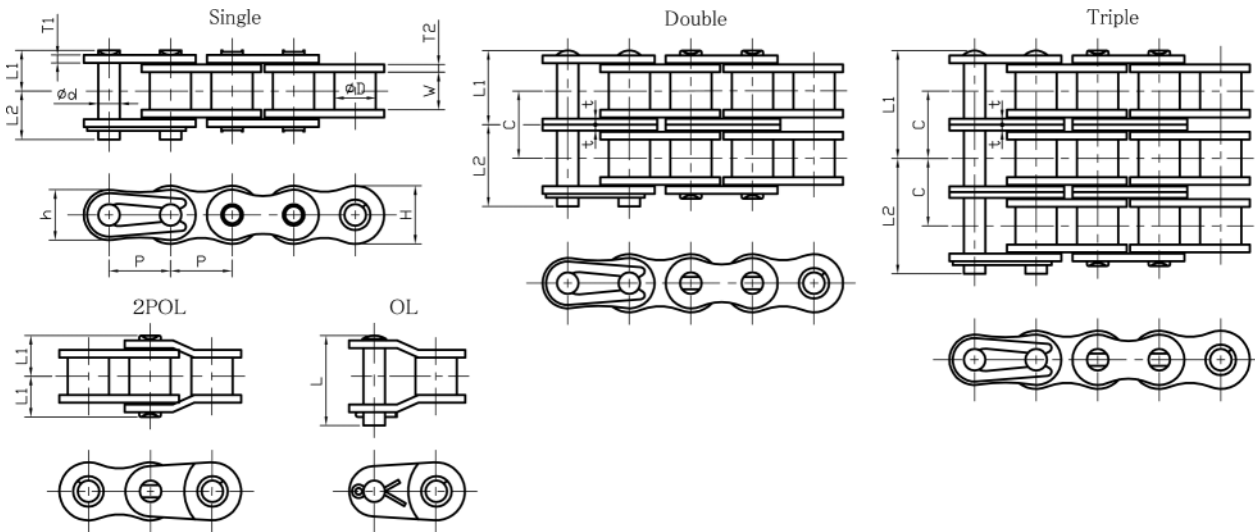

IZUMI Chain No.	Pitch	Pin			Transverse Pitch C	Roller		Plate				Minmum Tensile Strength(kN)	Weight (kg/m)	
		Diamater d	Length L1	Length L2		Diameter D	Width W	thickness T1	thickness T2	thickness t	Height h			Height H
ES10B	15.875	5.08	9.55	11.25	16.59	10.16	9.65	1.5	1.5	-	13.7	14.7	23	0.95
ES10B-2			17.85	19.55						1.5			44.5	1.85
ES10B-3			26.15	27.85						1.5			66.8	2.8
ES12B	19.05	5.72	11.1	13.0	19.46	12.07	11.68	1.7	1.8	-	16.1	16.1	31	1.25
ES12B-2			20.85	22.75						1.8			61	2.5
ES12B-3			30.6	32.5						1.8			92	3.8

EF06BSS ~ ES12BSS

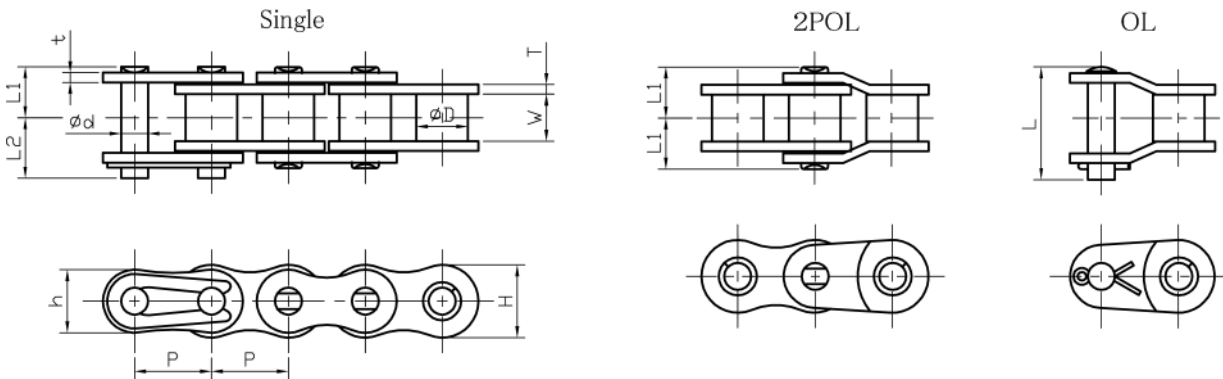

IZUMI Chain No.	Pitch	Pin			Roller		Plate				Minmum Tensile Strength(kN)	Weight (kg/m)
		Diamater d	Length L1	Length L2	Diameter D	Width W	thickness t	thickness T	Height h	Height H		
EF06BSS	9.525	3.28	6.5	7.25	6.35	5.72	1.0	1.27	8.2	8.2	5.2	0.39
ES08BSS	12.70	4.45	8.35	10.05	8.51	7.75	1.5	1.5	10.4	12.0	8.34	0.7
ES10BSS	15.875	5.08	7.55	11.25	10.16	9.65	1.5	1.5	13.7	14.7	11.8	0.95
ES12BSS	19.05	5.72	11.1	13.0	12.07	11.68	1.7	1.8	16.1	16.1	13.7	1.25

Specifications are subject to change without notice.